

# ASCENSION CATHOLIC CHURCH ADDITION & RENOVATION

Denver, Colorado | 2009 - 2010

A vibrant and growing parish in a working-class neighborhood in north Denver, Ascension Catholic Church is looking to improve its facilities and expand its capacity to better serve the many families who come to worship here.

Integration Design Group has been working with the parish leadership to develop a cost-effective, phased plan for growth, based on the community's current and future needs.

The proposed addition includes: an expanded Nave, adding approximately 250 seats to total 790 when complete; a new Sanctuary creating more worthy space for the Sacred Liturgy; a new Adoration Chapel with a modest bell tower rising above the altar of Exposition; and up to three new classrooms serving the parish's extensive program of religious education.

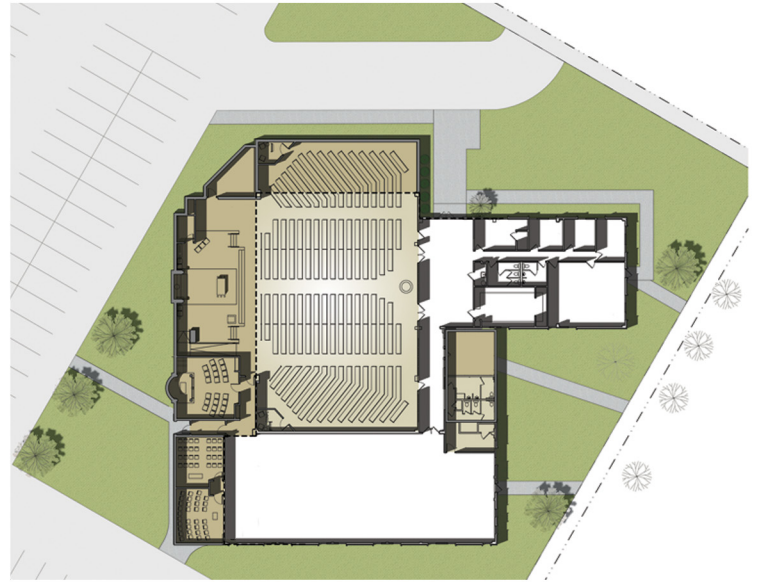

ARCHITECTURE

PLANNING

INTERIORS

**INTEGRATION DESIGN GROUP**

